



# Vinsco Sadhana



VINSCO SADHANA is an destination for achievers who are willing to achieve a perfect quality living at an affordable price in an prime residential location of Bangalore.

Vinsco offers you its best in style and quality 2 & 3 BHK apartments with all basic amenities and completely justified affordable prices @ one of the main location on hesarghatta road, near Peenya Dasarahalli, Bangalore.

### SPECIFICATIONS

**Structure:** RCC framed structure with solid block walls.

#### Plastering and painting:

- Internal and external walls with cement plastering.
- Internal painting: Walls and ceiling with putty and plastic emulsion paint.
- External painting: Weather proof paint with ruff finish.

#### Flooring and cladding:

- Vitrified tiles for Living, Dining, Kitchen and Bed rooms.
- Anti-skid tile flooring for Utility area and Bathrooms.
- Designer ceramic tiles up to 2' level above kitchen platform & up to 7' level from floor in Bathrooms.

#### Common Area:

- Granite flooring for the lobby, stair case and common passages.

#### Door & Windows:

- Entrance door with polished teak wood frame and poly fibre, water resistant, fire proof, teak finish shutter.
- All other doors with sal/honne frames with polyfibre/one side veneered flush door shutters.

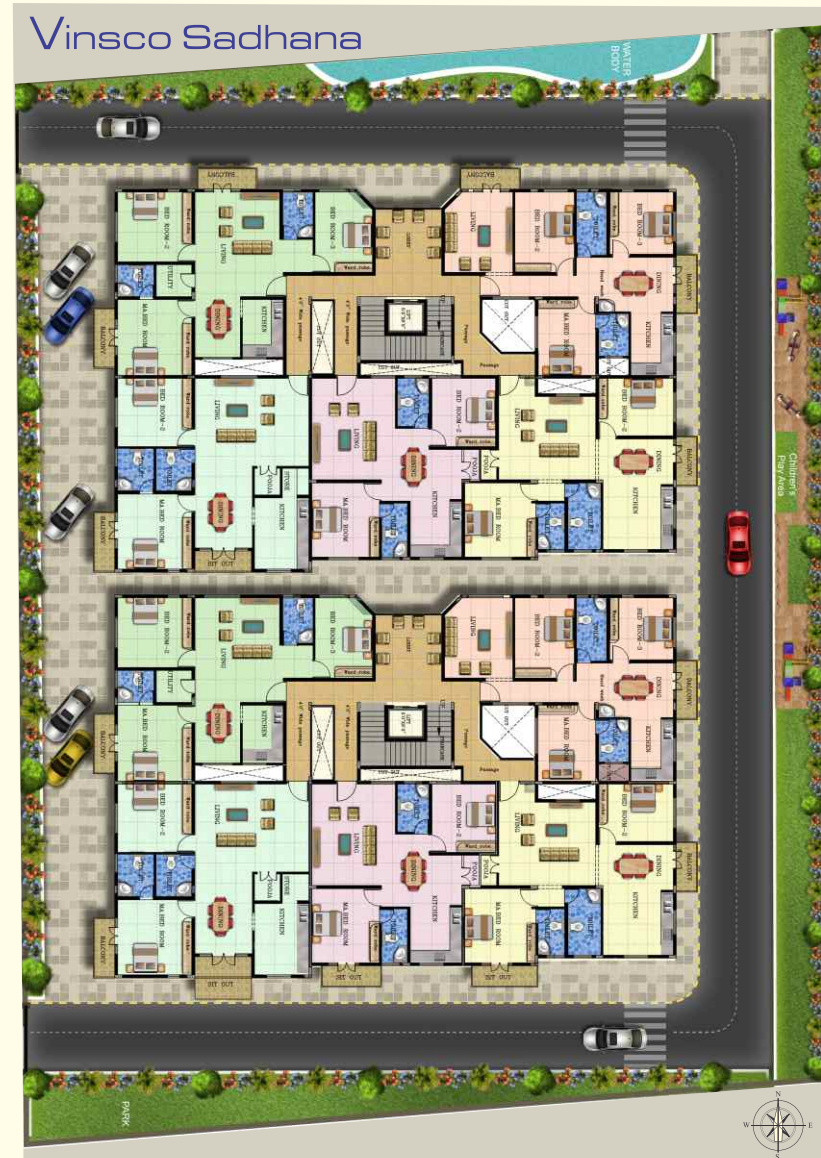

### Kitchen.

- Polished granite slab of 2' width for counter with stainless steel sink.
- Provision of exhaust fan, drinking water purifier.

### Bath rooms.

- CP fittings and sanitary fixtures of Parryware /Jaguar make or equivalent.
- Geyser in all bathrooms.

### Electrical:

- Electrical modular switches of Anchor roma make or equivalent.
- AC, TV & Telephone points in Master bedroom and Living rooms.
- Sufficient power outlets, light points and power sockets shall be provided at necessary places.

### INTERIORS

**Kitchen** : Designer modular cabinets.

**Living** : Designer TV unit.

**Bed room** : Separate wardrobes for ladies & men, Dressing table in master bed room, Study unit in children bed room.

**Car parking** : Stilt and closed car parking for owner and open car parking for visitors.

**Lifts** : 6-8 passenger automatic lift in each tower.

**Land scaping**: Open spaces shall be suitably land scaped.

**Apartment range starts from** : 1065 sq ft -1265 sqft (2BHK)

: 1120 sq ft- 1440 sqft (3BHK)

### AMENITIES:

1. CCTV cameras will be installed in the lobby, entrance and exit points.
2. Power backup for each flat, lifts & common areas.
3. Water body and land scape around the premises.
4. Community hall for yoga & meditation.
5. Solar lighting for common areas.
6. Borewells for drinking water.
7. Rain water harvesting.
8. Children play area and table tennis.
9. Automatic lifts.



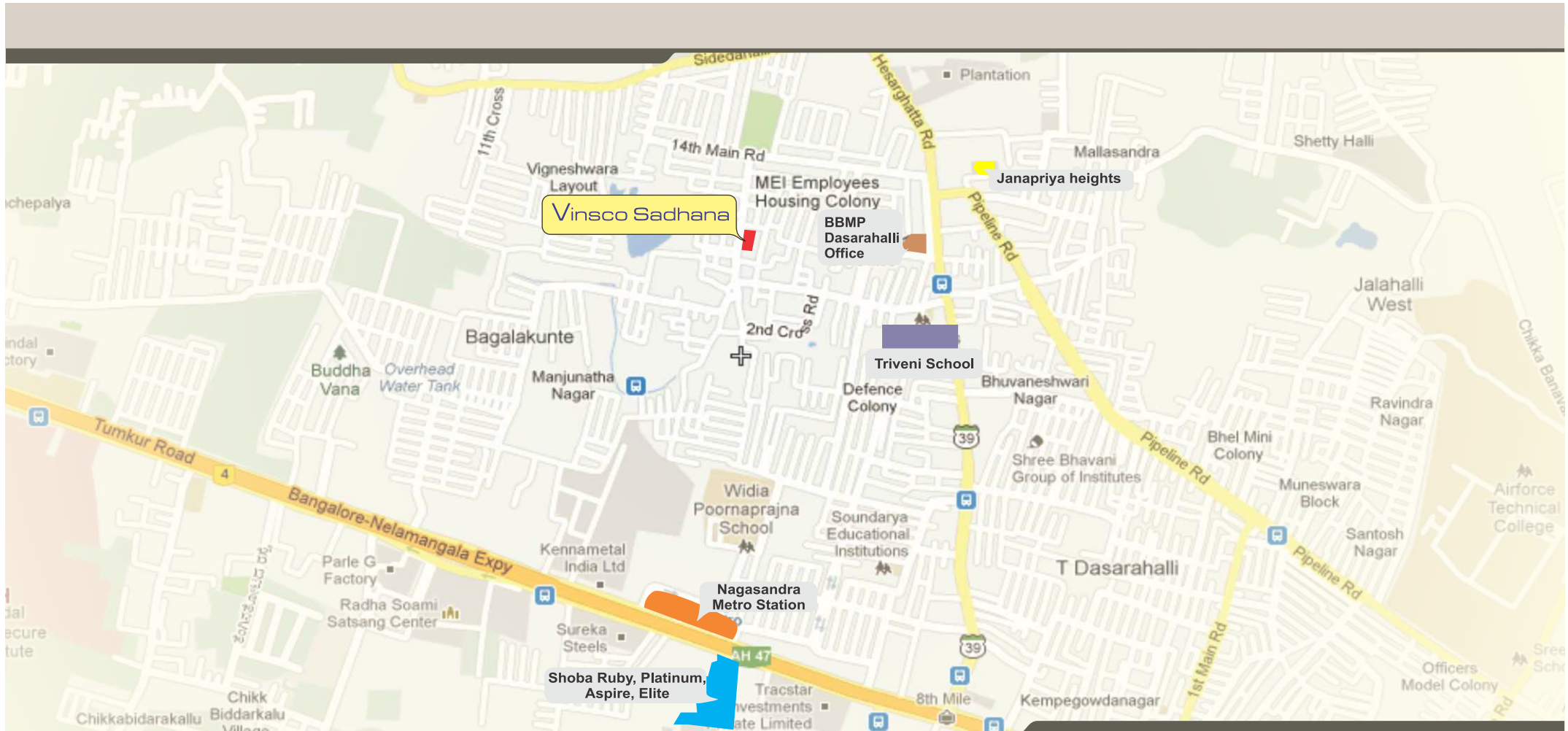

Developed by  
**VINSCO PROPERTIES PVT. LTD.**



Marketed by  
**VINSCO BUILDTECH PVT. LTD.**

**B. R. Somashekar**  
 Managing Director

**M. N. Pradeep**  
 Administrative Director

No. 81, "PREKSHA" 2nd Floor, 1st Main Road, Temple Street, Between 10th & 11th Cross, Malleshwaram, Bangalore - 03. Ph : 080 - 2346 6453 / 54.

email: [info@vinscogroup.com](mailto:info@vinscogroup.com). [www.vinscogroup.com](http://www.vinscogroup.com)

This brochure is a conceptual presentation only and not a legal offering. Concepts mentioned above are indicative only. The developer reserves right for alteration in plans elevations and specifications. All details are subject to change and any feature other than the ones specified above is at extra cost.